

M54 to M6 Link Road
TR010054
Volume 2
2.2 Land Plans

Regulation 5(2)(i)

Planning Act 2008

Infrastructure Planning (Applications: Prescribed
Forms and Procedure) Regulations 2009

January 2020

Infrastructure Planning

Planning Act 2008

**The Infrastructure Planning
(Applications: Prescribed Forms and
Procedure) Regulations 2009**

**M54 to M6 Link Road
Development Consent Order 202[]**

Land Plans

Regulation Number	Regulation 5(2)(i)
Planning Inspectorate Scheme Reference	TR010054
Application Document Reference	2.2
Author	M54 to M6 Link Road Project Team and Highways England

Version	Date	Status of Version
P01	January 2020	DCO Application

1 Schedule of Plans in this Application Document

Drawing Number	Drawing Title	Revision
HE514465-GHX-LLO-M54_SW_PR_Z-DR-LR-1000	LAND PLANS REGULATION 5(2)(i) KEY SHEET TR010054/APP/2.2	P03
HE514465-GHX-LLO-Z1_SW_PR_Z-DR-LR-1001	LAND PLANS REGULATION 5(2)(i) SHEET 1 OF 10 TR010054/APP/2.2	P06
HE514465-GHX-LLO-Z1_SW_PR_Z-DR-LR-1002	LAND PLANS REGULATION 5(2)(i) SHEET 2 OF 10 TR010054/APP/2.2	P06
HE514465-GHX-LLO-Z1_SW_PR_Z-DR-LR-1003	LAND PLANS REGULATION 5(2)(i) SHEET 3 OF 10 TR010054/APP/2.2	P06
HE514465-GHX-LLO-Z1_SW_PR_Z-DR-LR-1004	LAND PLANS REGULATION 5(2)(i) SHEET 4 OF 10 TR010054/APP/2.2	P06
HE514465 -GHX -LLO Z2_SW_PR_Z -DR-LR-1005	LAND PLANS REGULATION 5(2)(i) SHEET 5 OF 10 TR010054/APP/2.2	P06
HE514465 -GHX -LLO Z2_SW_PR_Z -DR-LR-1006	LAND PLANS REGULATION 5(2)(i) SHEET 6 OF 10 TR010054/APP/2.2	P06
HE514465-GHX-LLO-Z3_SW_PR_Z-DR-LR-1007	LAND PLANS REGULATION 5(2)(i) SHEET 7 OF 10 TR010054/APP/2.2	P06
HE514465-GHX-LLO-Z3_SW_PR_Z-DR-LR-1008	LAND PLANS REGULATION 5(2)(i) SHEET 8 OF 10 TR010054/APP/2.2	P06
HE514465-GHX-LLO-Z3_SW_PR_Z-DR-LR-1009	LAND PLANS REGULATION 5(2)(i) SHEET 9 OF 10 TR010054/APP/2.2	P06
HE514465-GHX-LLO-Z3_SW_PR_Z-DR-LR-1010	LAND PLANS REGULATION 5(2)(i) SHEET 10 OF 10 TR010054/APP/2.2	P06



- NOTES
1. ALL DIMENSIONS IN METRES UNLESS STATED OTHERWISE.
 2. DO NOT SCALE FROM THIS DRAWING. USE ONLY PRINTED DIMENSIONS.
 3. ALL EASEMENTS, SERVITUDES AND PRIVATE RIGHTS ARE PROPOSED TO BE EXTINGUISHED ON LAND THAT IS TO BE ACQUIRED UNLESS STATED OTHERWISE IN THE BOOK OF REFERENCE.
 4. THIS DRAWING IS TO BE READ IN CONJUNCTION WITH ALL OTHER PLANS AND DOCUMENTATION, IN PARTICULAR THE WORK PLANS AND THE BOOK OF REFERENCE.

- KEY
- LIMITS OF LAND TO BE ACQUIRED OR USED PERMANENTLY OR TEMPORARILY (THE ORDER LIMITS)
 - LAND NOT INCLUDED WITHIN THE ORDER LIMITS

First Issue	LD	SM	12/12/19	P01
Minor amendments to drawing frame	CH	SM	17/01/20	P02
Minor drawing frame amendments	CH	SM	24/01/20	P03
Revision Details	By	Check	Date	Suffix

DCO APPLICATION

Client:
Highways England
2 Colmore Square
38 Colmore Circus
Birmingham
B4 6BN



Development Consent Order Number
TR010054

Project Title
**M54 to M6
Link Road**

Development Consent Order Drawing Number
TR010054/APP/2.2

Drawing Title
**LAND PLANS
REGULATION 5(2)(i)
KEY SHEET**

Designed SM	Drawn CH	Checked JB	Approved SM	Date 24/01/20
Internal Project No. 60536736	Suitability S8			
Scale @ A1 1:20,000	Zone Development Consent Order			

THIS DOCUMENT HAS BEEN PREPARED PURSUANT TO AND SUBJECT TO THE TERMS OF AECOM'S APPOINTMENT BY ITS CLIENT. AECOM ACCEPTS NO LIABILITY FOR ANY USE OF THIS DOCUMENT OTHER THAN BY ITS ORIGINAL CLIENT OR FOLLOWING AECOM'S EXPRESS AGREEMENT TO SUCH USE, AND ONLY FOR THE PURPOSES FOR WHICH IT WAS PREPARED AND PROVIDED.

Drawing Number HE514465	Originator -GHX	Volume -LLO	Rev P03
M54_SW_PR_Z	-DR-LR-1000		
Location	Type	Role	Number

PLAN

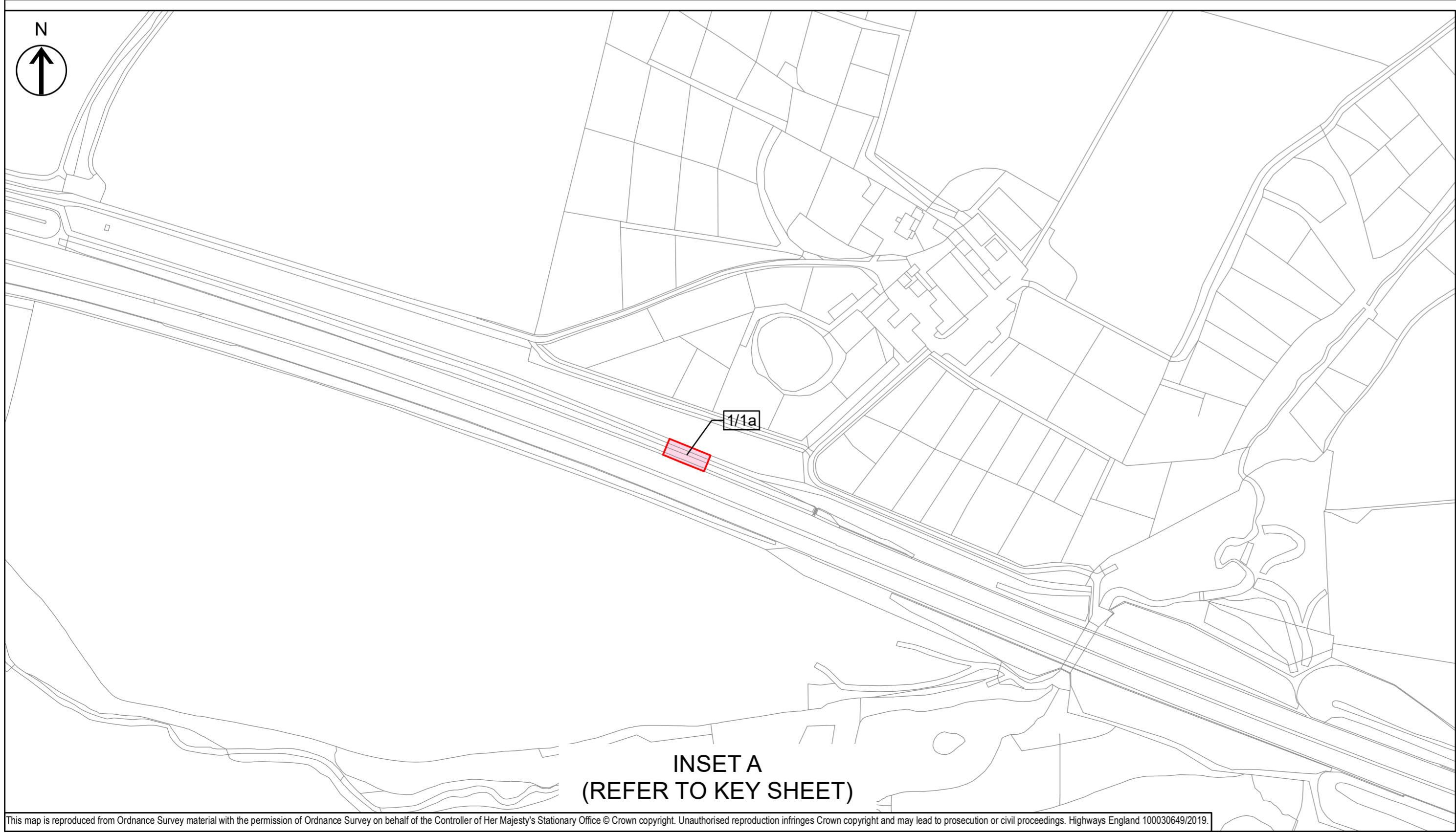

NOTES

1. ALL DIMENSIONS IN METRES UNLESS STATED OTHERWISE.
2. DO NOT SCALE FROM THIS DRAWING. USE ONLY PRINTED DIMENSIONS.
3. ALL EASEMENTS, SERVITUDES AND PRIVATE RIGHTS ARE PROPOSED TO BE EXTINGUISHED ON LAND THAT IS TO BE ACQUIRED UNLESS STATED OTHERWISE IN THE BOOK OF REFERENCE.
4. THIS DRAWING IS TO BE READ IN CONJUNCTION WITH ALL OTHER PLANS AND DOCUMENTATION, IN PARTICULAR THE WORK PLANS AND THE BOOK OF REFERENCE.

KEY

- LIMITS OF LAND TO BE ACQUIRED OR USED PERMANENTLY OR TEMPORARILY (THE ORDER LIMITS)
- PLOT REFERENCE NUMBER (REFER TO BOOK OF REFERENCE FOR FURTHER INFORMATION)
- LAND NOT INCLUDED WITHIN THE ORDER LIMITS
- LAND TO BE ACQUIRED
- LAND TO BE USED TEMPORARILY
- LAND TO BE USED TEMPORARILY AND RIGHTS TO BE ACQUIRED PERMANENTLY
- NO POWERS SOUGHT IN DCO

Issue	LD	SM	Date	Suffix
First Issue	LD	SM	21/10/19	P01
Update following client review	LD	SM	05/11/19	P02
Minor amendments to drawing frame	LD	SM	22/11/19	P03
Pre DCO Submission Amendments	LD	SM	16/12/19	P04
Plot amendments following client review	CH	SM	16/01/20	P05
Updates to plot numbers and minor drawing frame amendments	CH	SM	24/01/20	P06
Revision Details	By	Check	Date	Suffix

DCO APPLICATION

Client:
Highways England
2 Colmore Square
38 Colmore Circus
Birmingham
B4 6BN



Development Consent Order Number
TR010054

Project Title
M54 to M6 Link Road

Development Consent Order Drawing Number
TR010054/APP/2.2

Drawing Title
LAND PLANS REGULATION 5(2)(i) SHEET 1 OF 10

Designed	Drawn	Checked	Approved	Date
SM	CH	JB	SM	24/01/20

Internal Project No. 60536736
Scale @ A1 1:2500
Sustainability S8
Zone Development Consent Order

THIS DOCUMENT HAS BEEN PREPARED PURSUANT TO AND SUBJECT TO THE TERMS OF AECOM'S APPOINTMENT BY ITS CLIENT. AECOM ACCEPTS NO LIABILITY FOR ANY USE OF THIS DOCUMENT OTHER THAN BY ITS ORIGINAL CLIENT OR FOLLOWING AECOM'S EXPRESS AGREEMENT TO SUCH USE, AND ONLY FOR THE PURPOSES FOR WHICH IT WAS PREPARED AND PROVIDED.

Drawing Number	Highways England PIN	Originator	Volume	Rev
HE514465	-GHX	-LLO		P06
Z1_SW_PR_Z		-DR-LR-1001		
Location	Type	Role	Number	



This map is reproduced from Ordnance Survey material with the permission of Ordnance Survey on behalf of the Controller of Her Majesty's Stationary Office © Crown copyright. Unauthorised reproduction infringes Crown copyright and may lead to prosecution or civil proceedings. Highways England 100030649/2019

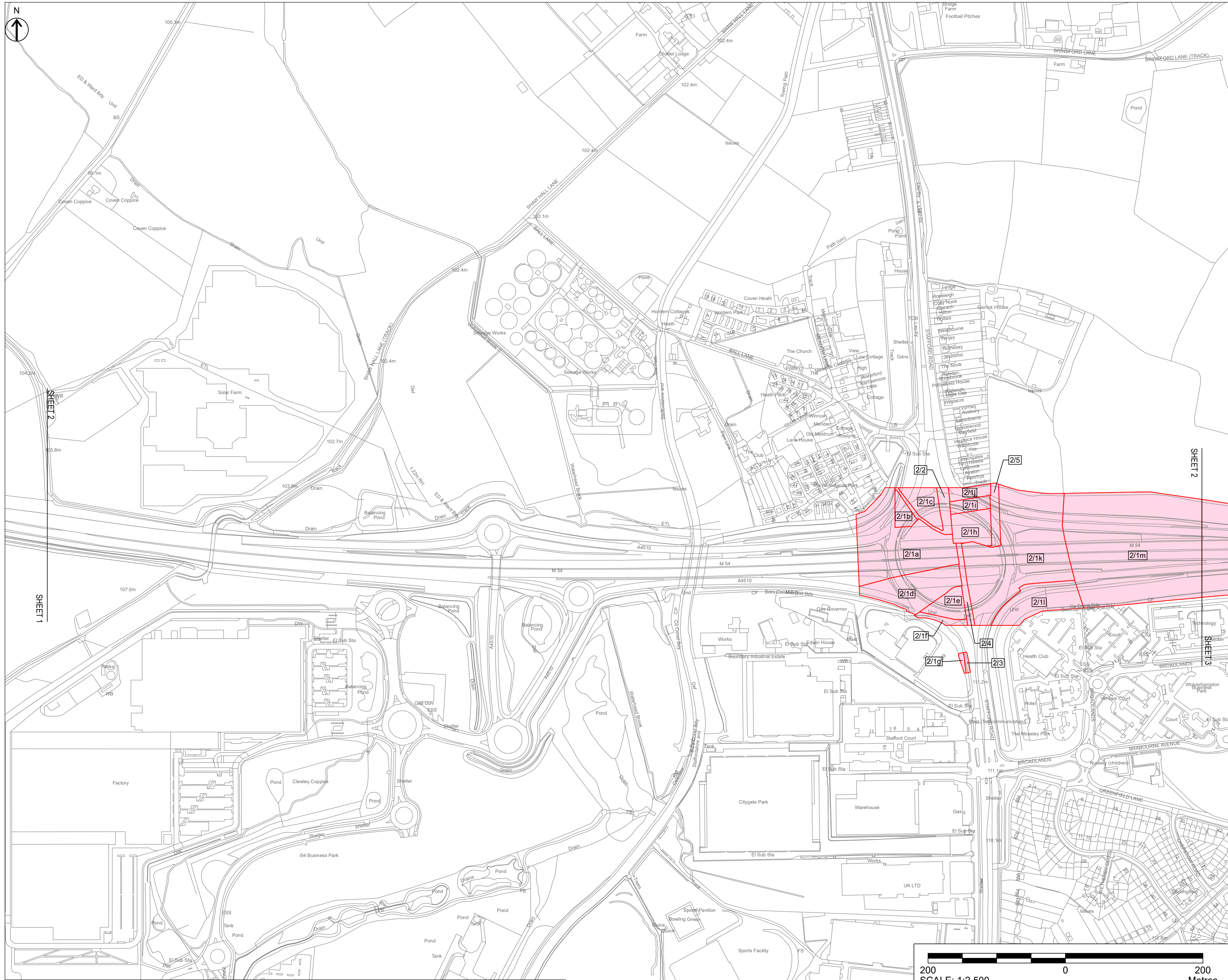

- NOTES**
1. ALL DIMENSIONS IN METRES UNLESS STATED OTHERWISE.
 2. DO NOT SCALE FROM THIS DRAWING. USE ONLY PRINTED DIMENSIONS.
 3. ALL EASEMENTS, SERVITUDES AND PRIVATE RIGHTS ARE PROPOSED TO BE EXTINGUISHED ON LAND THAT IS TO BE ACQUIRED UNLESS STATED OTHERWISE IN THE BOOK OF REFERENCE.
 4. THIS DRAWING IS TO BE READ IN CONJUNCTION WITH ALL OTHER PLANS AND DOCUMENTATION. IN PARTICULAR THE WORK PLANS AND THE BOOK OF REFERENCE.

- KEY**
- LIMITS OF LAND TO BE ACQUIRED OR USED PERMANENTLY OR TEMPORARILY (THE ORDER LIMITS)
 - 23 PLOT REFERENCE NUMBER (REFER TO BOOK OF REFERENCE FOR FURTHER INFORMATION)
 - LAND NOT INCLUDED WITHIN THE ORDER LIMITS
 - LAND TO BE ACQUIRED PERMANENTLY
 - LAND TO BE USED TEMPORARILY
 - LAND TO BE USED TEMPORARILY AND RIGHTS TO BE ACQUIRED PERMANENTLY
 - NO POWERS SOUGHT IN DCO

First Issue	LD	SM	21/10/19	P01
Update following client review	LD	SM	05/11/19	P02
Minor amendments to drawing frame	LD	SM	22/11/19	P03
Pre DCO Submission Amendments	LD	SM	16/12/19	P04
Plot amendments following client review	CH	SM	16/01/20	P05
Updates to plot numbers and minor drawing frame amendments	CH	SM	24/01/20	P06
Revision Details	By	Check	Date	Suffix

DCO APPLICATION

Client
Highways England
2 Colmore Square
38 Colmore Circus
Birmingham
B4 6BN



Development Consent Order Number
TR010054

Project Title
M54 to M6 Link Road

Development Consent Order Drawing Number
TR010054/APP/2.2

Drawing Title
**LAND PLANS
REGULATION 5(2)(i)
SHEET 2 OF 10**

Designed SM	Drawn CH	Checked JB	Approved SM	Date 24/01/20
Internal Project No. 60536736			Suitability S8	
Scale @ A1 1:2500			Zone Development Consent Order	

THIS DOCUMENT HAS BEEN PREPARED PURSUANT TO AND SUBJECT TO THE TERMS OF AECOM'S APPOINTMENT BY ITS CLIENT. AECOM ACCEPTS NO LIABILITY FOR ANY USE OF THIS DOCUMENT OTHER THAN BY ITS ORIGINAL CLIENT OR FOLLOWING AECOM'S EXPRESS AGREEMENT TO SUCH USE, AND ONLY FOR THE PURPOSES FOR WHICH IT WAS PREPARED AND PROVIDED.

Drawing Number HE514465	Originator -GHX	Volume -LLO	Rev P06
Location Z1_SW_PR_Z	Type -DR-LR-1002	Role -DR-LR-1002	Number

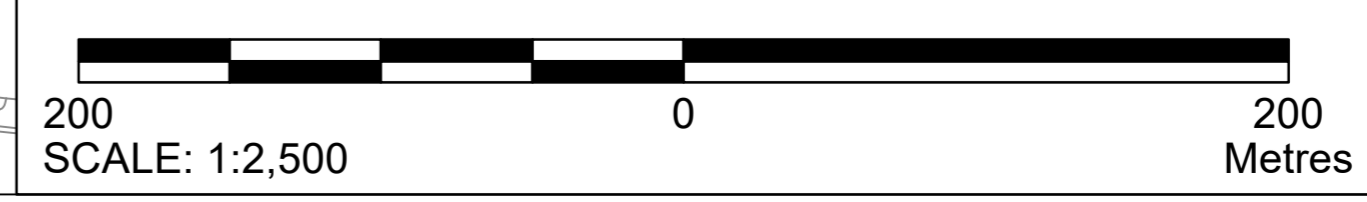

This map is reproduced from Ordnance Survey material with the permission of Ordnance Survey on behalf of the Controller of Her Majesty's Stationary Office © Crown copyright. Unauthorised reproduction infringes Crown copyright and may lead to prosecution or civil proceedings. Highways England 10003649/2019

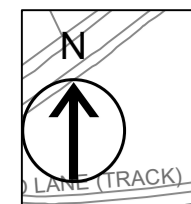
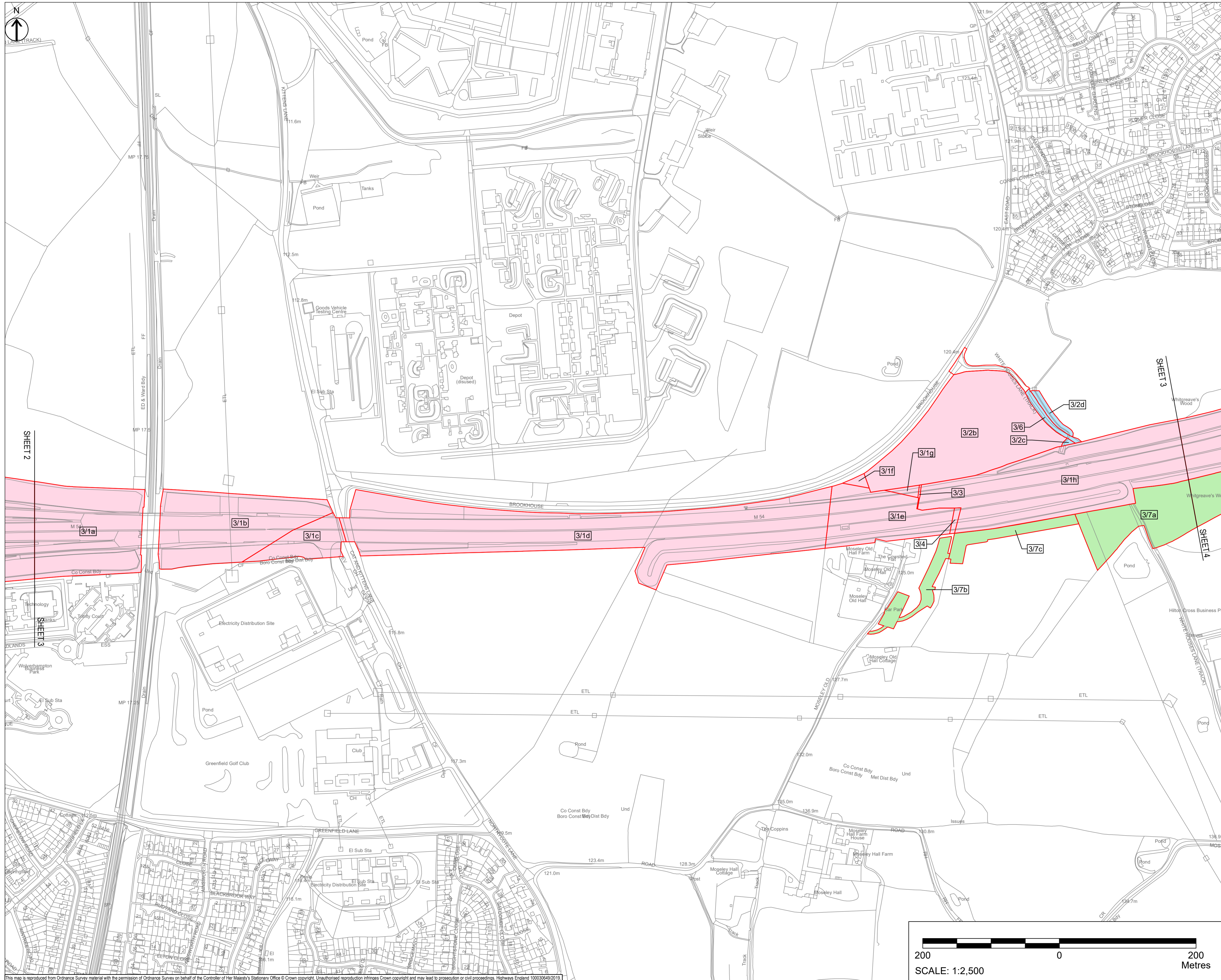

- NOTES**
1. ALL DIMENSIONS IN METRES UNLESS STATED OTHERWISE.
 2. DO NOT SCALE FROM THIS DRAWING. USE ONLY PRINTED DIMENSIONS.
 3. ALL EASEMENTS, SERVITUDES AND PRIVATE RIGHTS ARE PROPOSED TO BE EXTINGUISHED ON LAND THAT IS TO BE ACQUIRED UNLESS STATED OTHERWISE IN THE BOOK OF REFERENCE.
 4. THIS DRAWING IS TO BE READ IN CONJUNCTION WITH ALL OTHER PLANS AND DOCUMENTATION, IN PARTICULAR THE WORK PLANS AND THE BOOK OF REFERENCE.

- KEY**
- LIMITS OF LAND TO BE ACQUIRED OR USED PERMANENTLY OR TEMPORARILY (THE ORDER LIMITS)
 - 123 — PLOT REFERENCE NUMBER (REFER TO BOOK OF REFERENCE FOR FURTHER INFORMATION)
 - LAND NOT INCLUDED WITHIN THE ORDER LIMITS
 - LAND TO BE ACQUIRED
 - LAND TO BE USED TEMPORARILY
 - LAND TO BE USED TEMPORARILY AND RIGHTS TO BE ACQUIRED PERMANENTLY
 - NO POWERS SOUGHT IN DCO

First Issue	LD	SM	21/10/19	P01
Update following client review	LD	SM	05/11/19	P02
Minor amendments to drawing frame	LD	SM	22/11/19	P03
Pre DCO Submission Amendments	LD	SM	16/12/19	P04
Plot amendments following client review	CH	SM	16/01/20	P05
Updates to plot numbers and minor drawing frame amendments	CH	SM	24/01/20	P06
Revision Details	By	Check	Date	Suffix

DCO APPLICATION

Client:
Highways England
2 Colmore Square
38 Colmore Circus
Birmingham
B4 6BN



Development Consent Order Number:
TR010054

Project Title:
M54 to M6 Link Road

Development Consent Order Drawing Number:
TR010054/APP/2.2

Drawing Title:
**LAND PLANS
REGULATION 5(2)(i)
SHEET 3 OF 10**

Designed	Drawn	Checked	Approved	Date
SM	CH	JB	SM	24/01/20

Internal Project No.
60536736

Scale @ A1
1:2500

Suitability
S8

Zone
Development Consent Order

THIS DOCUMENT HAS BEEN PREPARED PURSUANT TO AND SUBJECT TO THE TERMS OF AECOM'S APPOINTMENT BY ITS CLIENT. AECOM ACCEPTS NO LIABILITY FOR ANY USE OF THIS DOCUMENT OTHER THAN BY ITS ORIGINAL CLIENT OR FOLLOWING AECOM'S EXPRESS AGREEMENT TO SUCH USE, AND ONLY FOR THE PURPOSES FOR WHICH IT WAS PREPARED AND PROVIDED.

Drawing Number	Originator	Volume	Rev
HE514465	-GHX	-LLO	P06
Z1_SW_PR_Z	-DR-LR-1003		
Location	Type	Role	Number

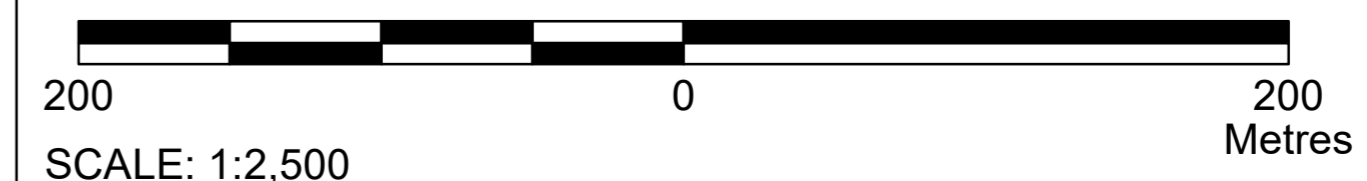

This map is reproduced from Ordnance Survey material with the permission of Ordnance Survey on behalf of the Controller of Her Majesty's Stationary Office © Crown copyright. Unauthorised reproduction infringes Crown copyright and may lead to prosecution or civil proceedings. Highways England 10003049/2019

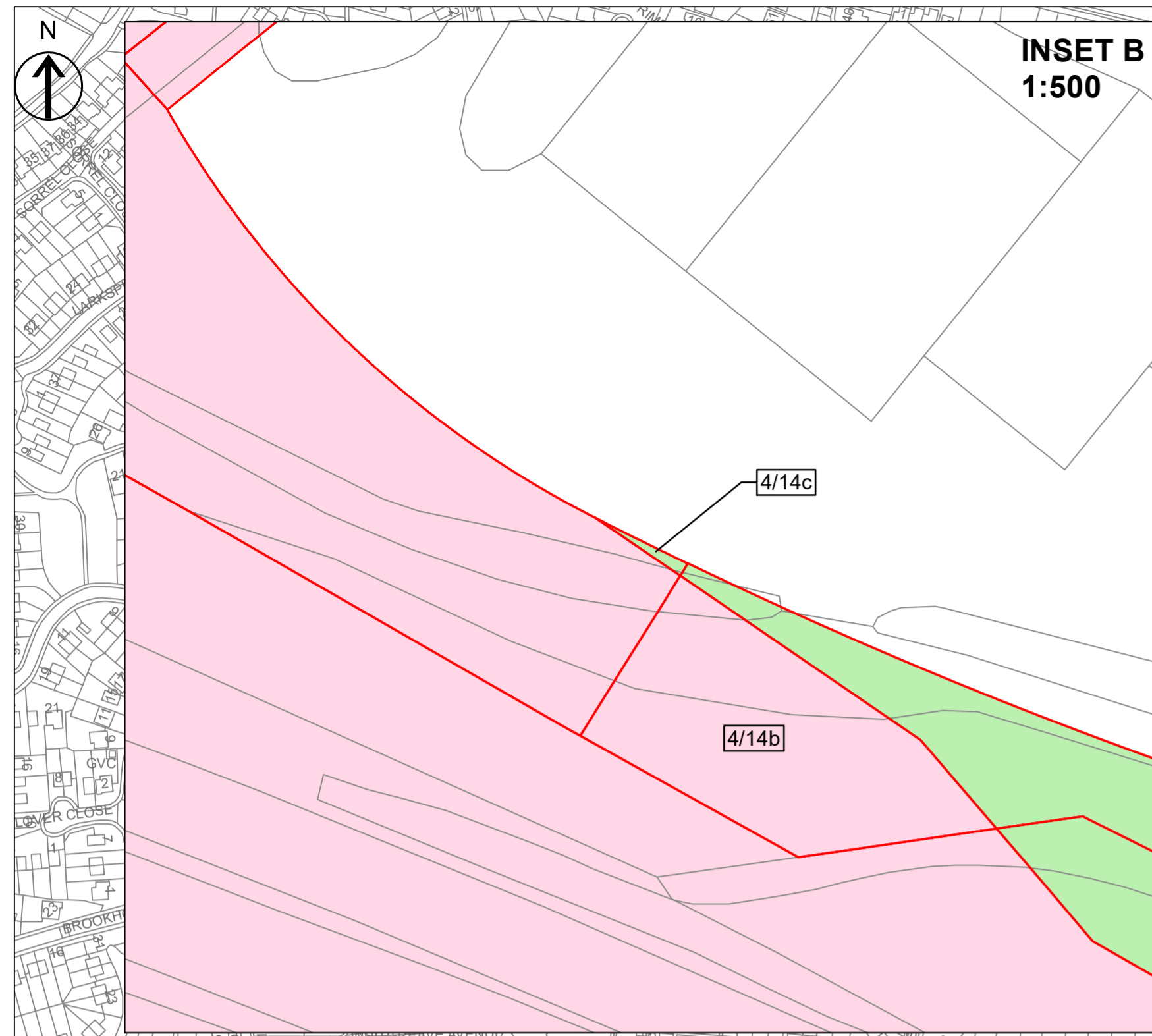
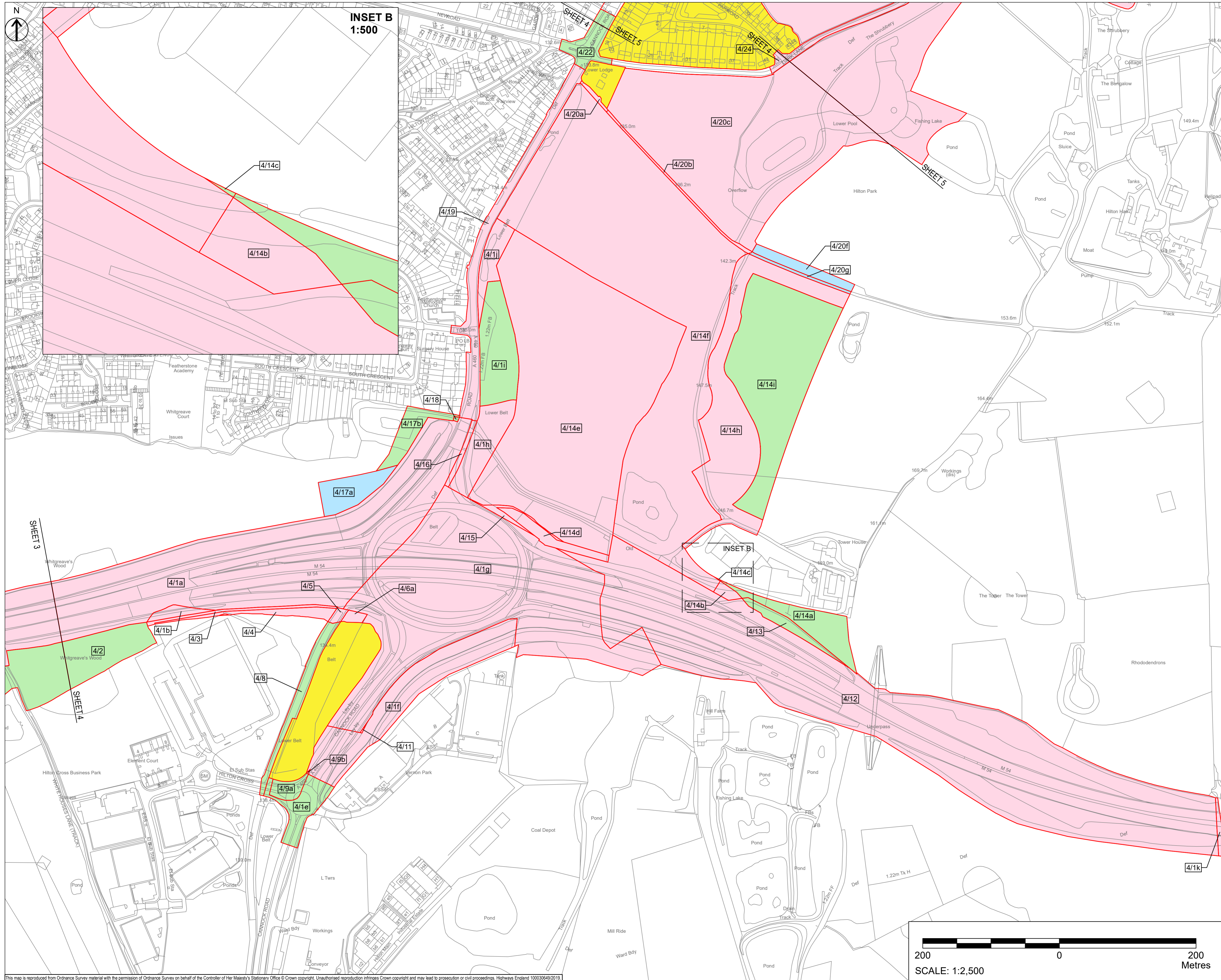

- NOTES**
1. ALL DIMENSIONS IN METRES UNLESS STATED OTHERWISE.
 2. DO NOT SCALE FROM THIS DRAWING. USE ONLY PRINTED DIMENSIONS.
 3. ALL EASEMENTS, SERVITUDES AND PRIVATE RIGHTS ARE PROPOSED TO BE EXTINGUISHED ON LAND THAT IS TO BE ACQUIRED UNLESS STATED OTHERWISE IN THE BOOK OF REFERENCE.
 4. THIS DRAWING IS TO BE READ IN CONJUNCTION WITH ALL OTHER PLANS AND DOCUMENTATION, IN PARTICULAR THE WORK PLANS AND THE BOOK OF REFERENCE.

- KEY**
- LIMITS OF LAND TO BE ACQUIRED OR USED PERMANENTLY OR TEMPORARILY (THE ORDER LIMITS)
 - PLOT REFERENCE NUMBER (REFER TO BOOK OF REFERENCE FOR FURTHER INFORMATION)
 - LAND NOT INCLUDED WITHIN THE ORDER LIMITS
 - LAND TO BE ACQUIRED PERMANENTLY
 - LAND TO BE USED TEMPORARILY
 - LAND TO BE USED TEMPORARILY AND RIGHTS TO BE ACQUIRED PERMANENTLY
 - NO POWERS SOUGHT IN DCO

Revision	LD	SM	Date	Issue
First Issue	LD	SM	21/10/19	P01
Update following client review	LD	SM	05/11/19	P02
Minor amendments to drawing frame	LD	SM	22/11/19	P03
Pre DCO Submission Amendments	LD	SM	16/12/19	P04
Plot amendments following client review	CH	SM	16/01/20	P05
Updates to plot numbers and minor drawing frame amendments	CH	SM	24/01/20	P06
Revision Details	By	Check	Date	Suffix

DCO APPLICATION

Client:
Highways England
2 Colmore Square
38 Colmore Circus
Birmingham
B4 6BN



Development Consent Order Number
TR010054

Project Title
M54 to M6 Link Road

Development Consent Order Drawing Number
TR010054/APP/2.2

**LAND PLANS
REGULATION 5(2)(i)
SHEET 4 OF 10**

Designed SM	Drawn CH	Checked JB	Approved SM	Date 24/01/20
Internal Project No. 60536736	Subsidiary S8	Zone Development Consent Order		

THIS DOCUMENT HAS BEEN PREPARED PURSUANT TO AND SUBJECT TO THE TERMS OF AECOM'S APPOINTMENT BY ITS CLIENT. AECOM ACCEPTS NO LIABILITY FOR ANY USE OF THIS DOCUMENT OTHER THAN BY ITS ORIGINAL CLIENT OR FOLLOWING AECOM'S EXPRESS AGREEMENT TO SUCH USE, AND ONLY FOR THE PURPOSES FOR WHICH IT WAS PREPARED AND PROVIDED.

Drawing Number HE514465	Originator -GHX	Volume -LLO	Rev P06
Z1_SW_PR_Z	-DR-LR-1004		
Location	Type	Role	Number



This map is reproduced from Ordnance Survey material with the permission of Ordnance Survey on behalf of the Controller of Her Majesty's Stationary Office © Crown copyright. Unauthorised reproduction infringes Crown copyright and may lead to prosecution or civil proceedings. Highways England 10003649/2019

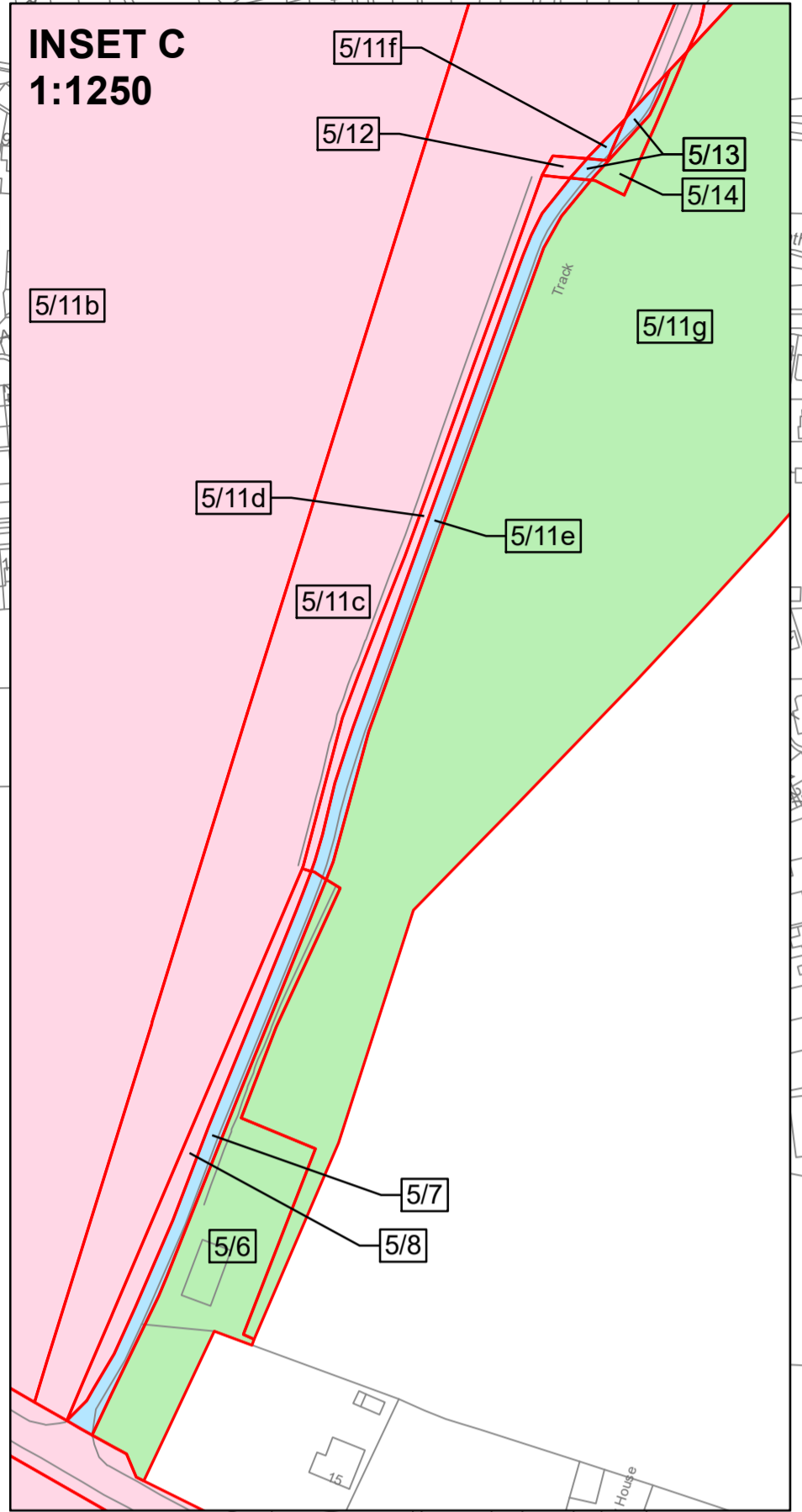
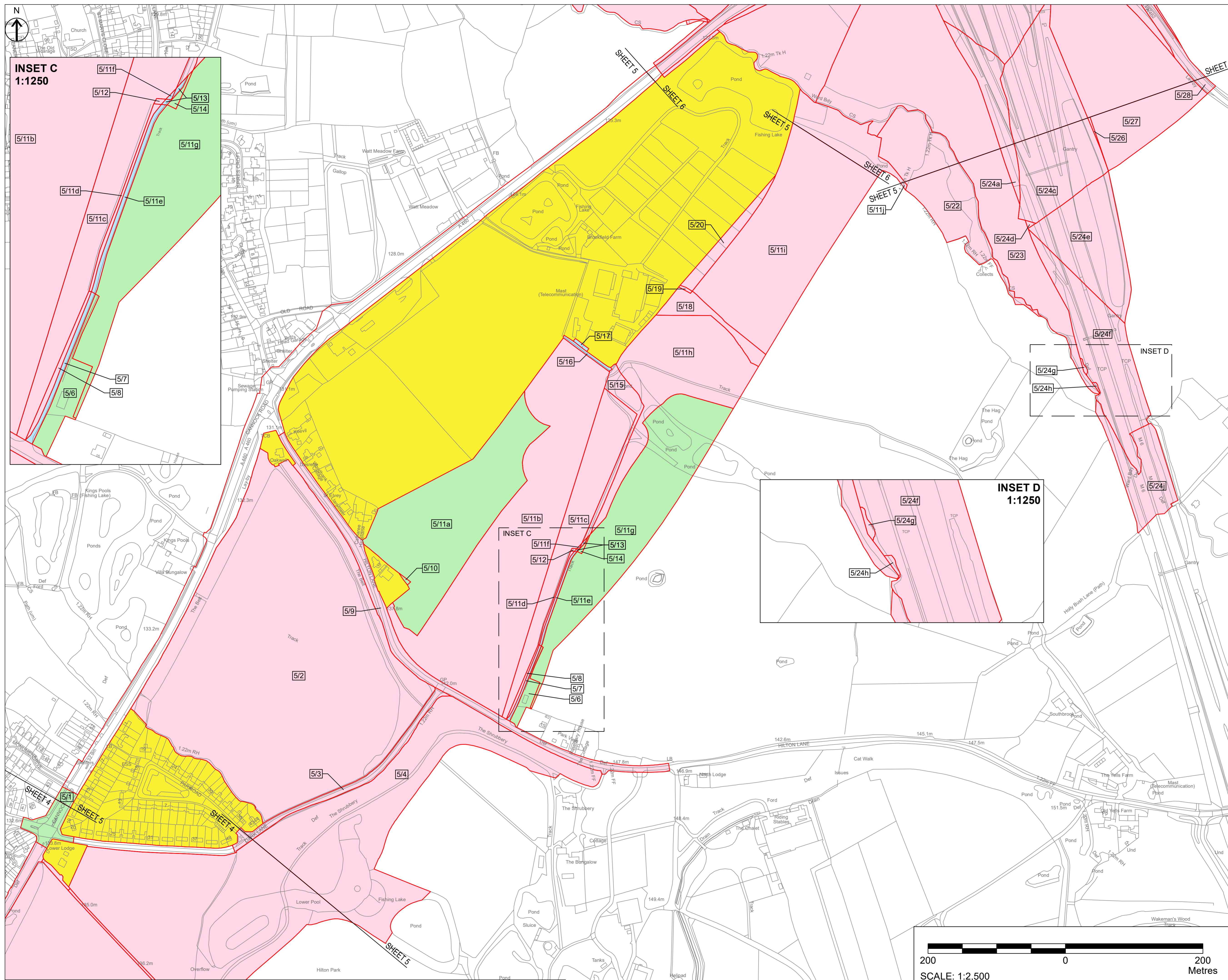

- NOTES**
1. ALL DIMENSIONS IN METRES UNLESS STATED OTHERWISE.
 2. DO NOT SCALE FROM THIS DRAWING. USE ONLY PRINTED DIMENSIONS.
 3. ALL EASEMENTS, SERVITUDES AND PRIVATE RIGHTS ARE PROPOSED TO BE EXTINGUISHED ON LAND THAT IS TO BE ACQUIRED UNLESS STATED OTHERWISE IN THE BOOK OF REFERENCE.
 4. THIS DRAWING IS TO BE READ IN CONJUNCTION WITH ALL OTHER PLANS AND DOCUMENTATION, IN PARTICULAR THE WORK PLANS AND THE BOOK OF REFERENCE.

- KEY**
- LIMITS OF LAND TO BE ACQUIRED OR USED PERMANENTLY OR TEMPORARILY (THE ORDER LIMITS)
 - PLOT REFERENCE NUMBER (REFER TO BOOK OF REFERENCE FOR FURTHER INFORMATION)
 - LAND NOT INCLUDED WITHIN THE ORDER LIMITS
 - LAND TO BE ACQUIRED PERMANENTLY
 - LAND TO BE USED TEMPORARILY
 - LAND TO BE USED TEMPORARILY AND RIGHTS TO BE ACQUIRED PERMANENTLY
 - NO POWERS SOUGHT IN DCO

First Issue	LD	SM	21/10/19	P01
Update following client review	LD	SM	05/11/19	P02
Minor amendments to drawing frame	LD	SM	22/11/19	P03
Pre DCO Submission Amendments	LD	SM	16/12/19	P04
Plot amendments following client review	CH	SM	16/01/20	P05
Updates to plot numbers and minor drawing frame amendments	CH	SM	24/01/20	P06
Revision Details	By	Check	Date	Suffix

DCO APPLICATION

Client:
Highways England
2 Colmore Square
38 Colmore Circus
Birmingham
B4 6BN



Development Consent Order Number
TR010054

Project Title
M54 to M6 Link Road

Development Consent Order Drawing Number
TR010054/APP/2.2

Drawing Title
**LAND PLANS
REGULATION 5(2)(i)
SHEET 5 OF 10**

Designed	Drawn	Checked	Approved	Date
SM	CH	JB	SM	24/01/20
Internal Project No. 60536736	Suitability --			
Scale @ A1 1:2500	Zone Whole Site			

THIS DOCUMENT HAS BEEN PREPARED PURSUANT TO AND SUBJECT TO THE TERMS OF AECOM'S APPOINTMENT BY ITS CLIENT. AECOM ACCEPTS NO LIABILITY FOR ANY USE OF THIS DOCUMENT OTHER THAN BY ITS ORIGINAL CLIENT OR FOLLOWING AECOM'S EXPRESS AGREEMENT TO SUCH USE, AND ONLY FOR THE PURPOSES FOR WHICH IT WAS PREPARED AND PROVIDED.

Drawing Number	Originator	Volume	Rev
HE514465 -GHX	-LLO		P06
Z2_SW_PR_Z	-DR-LR-1005		
Location	Type	Role	Number



This map is reproduced from Ordnance Survey material with the permission of Ordnance Survey on behalf of the Controller of Her Majesty's Stationery Office © Crown copyright. Unauthorised reproduction infringes Crown copyright and may lead to prosecution or civil proceedings. Highways England 10003649/2019

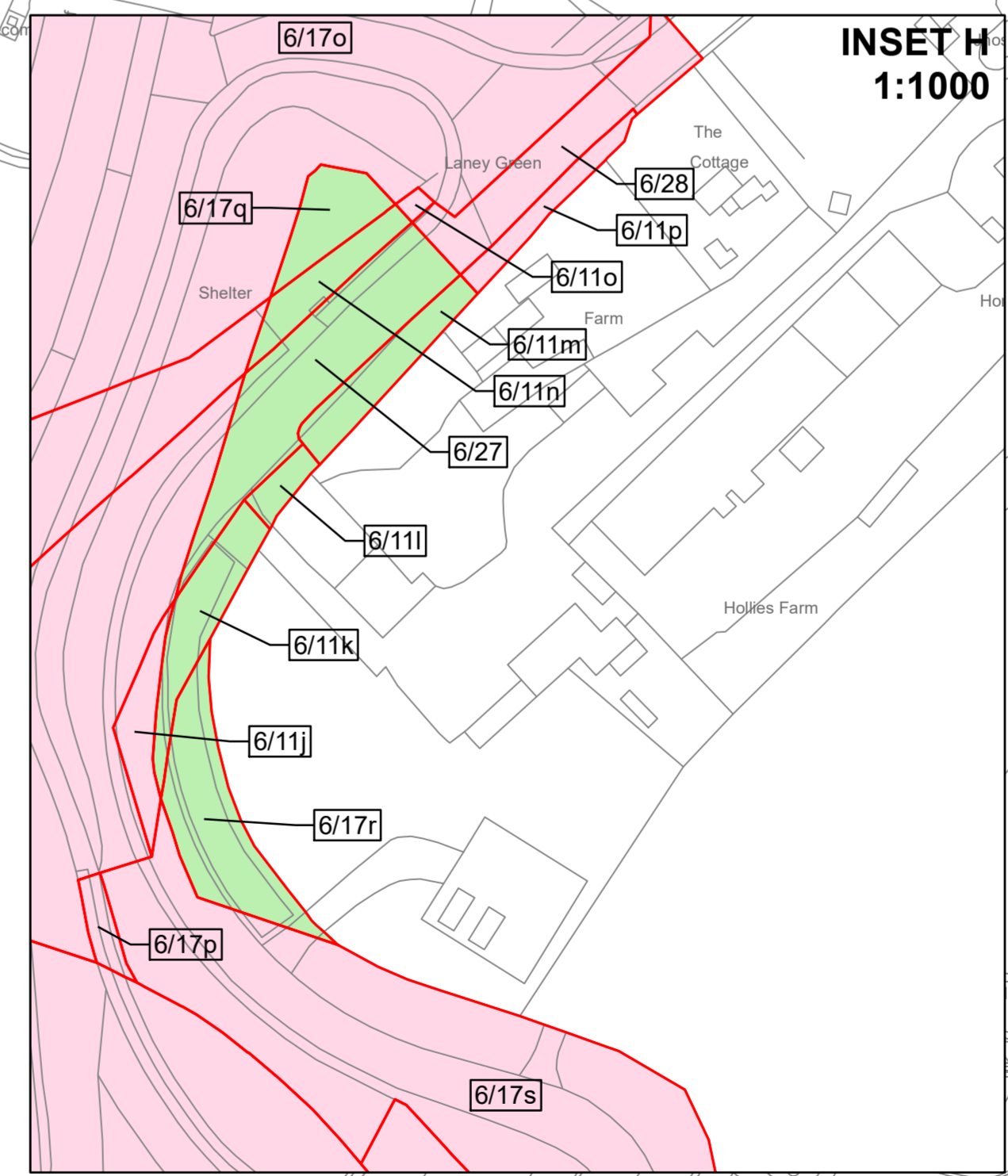
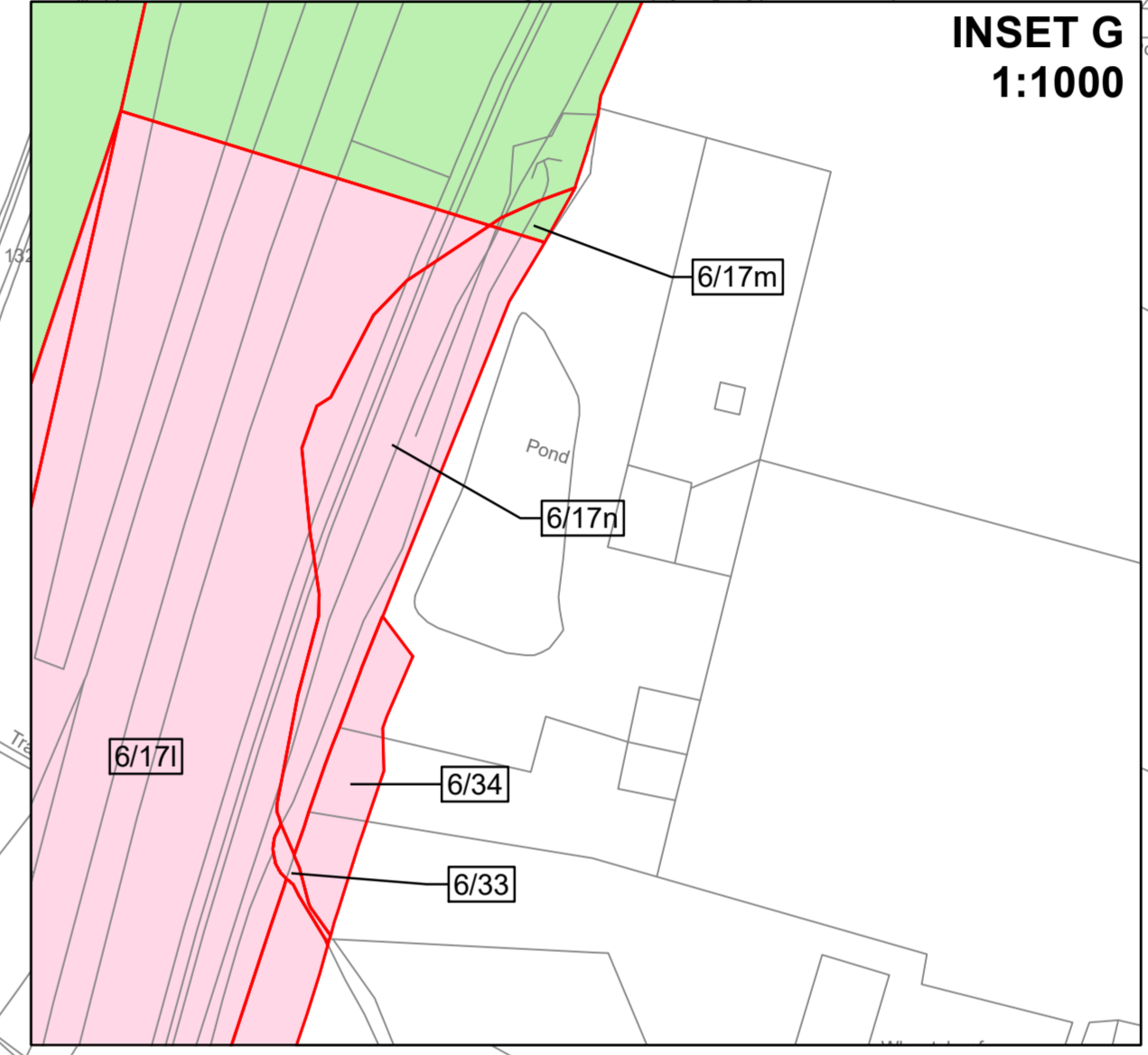
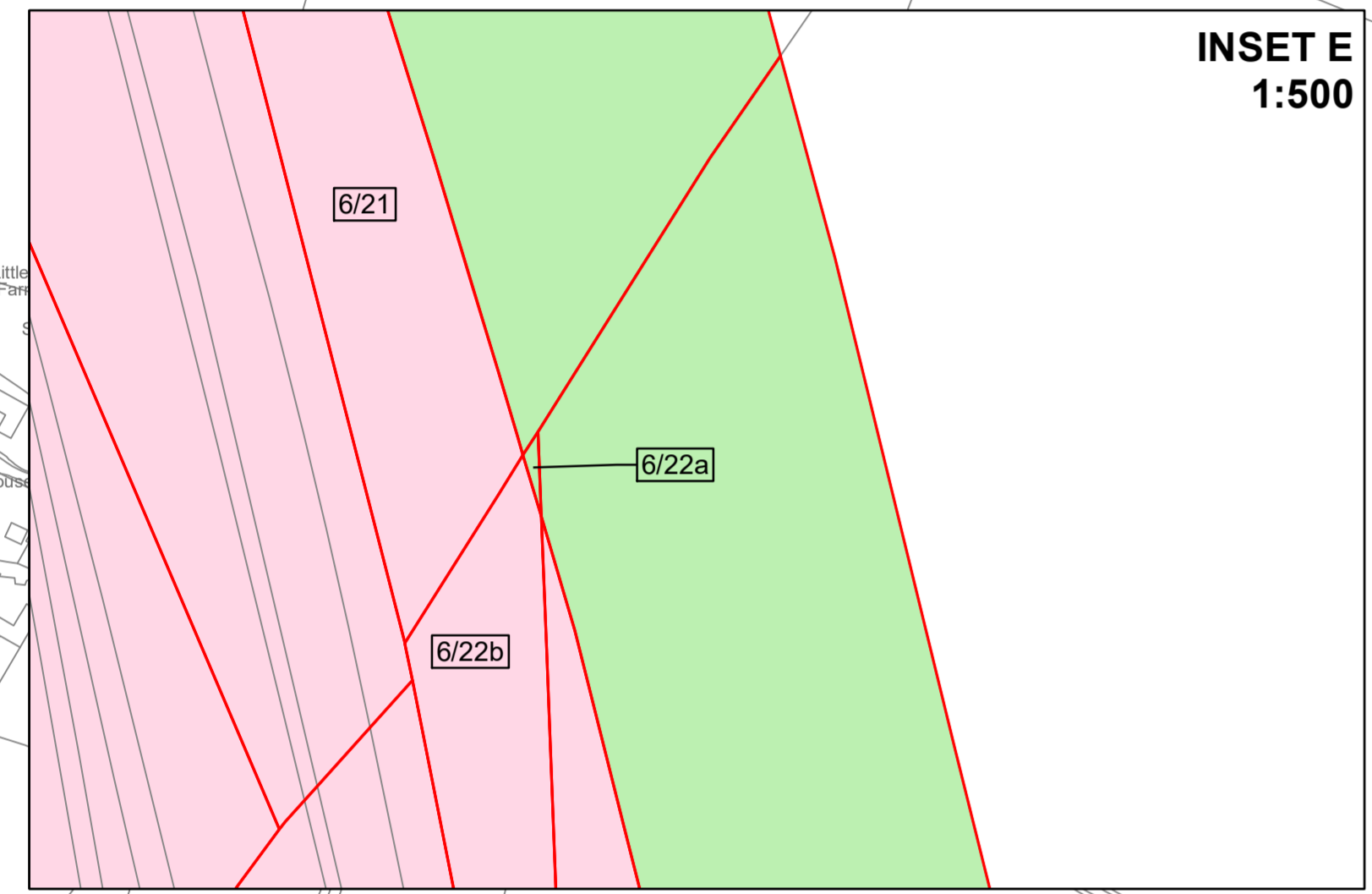
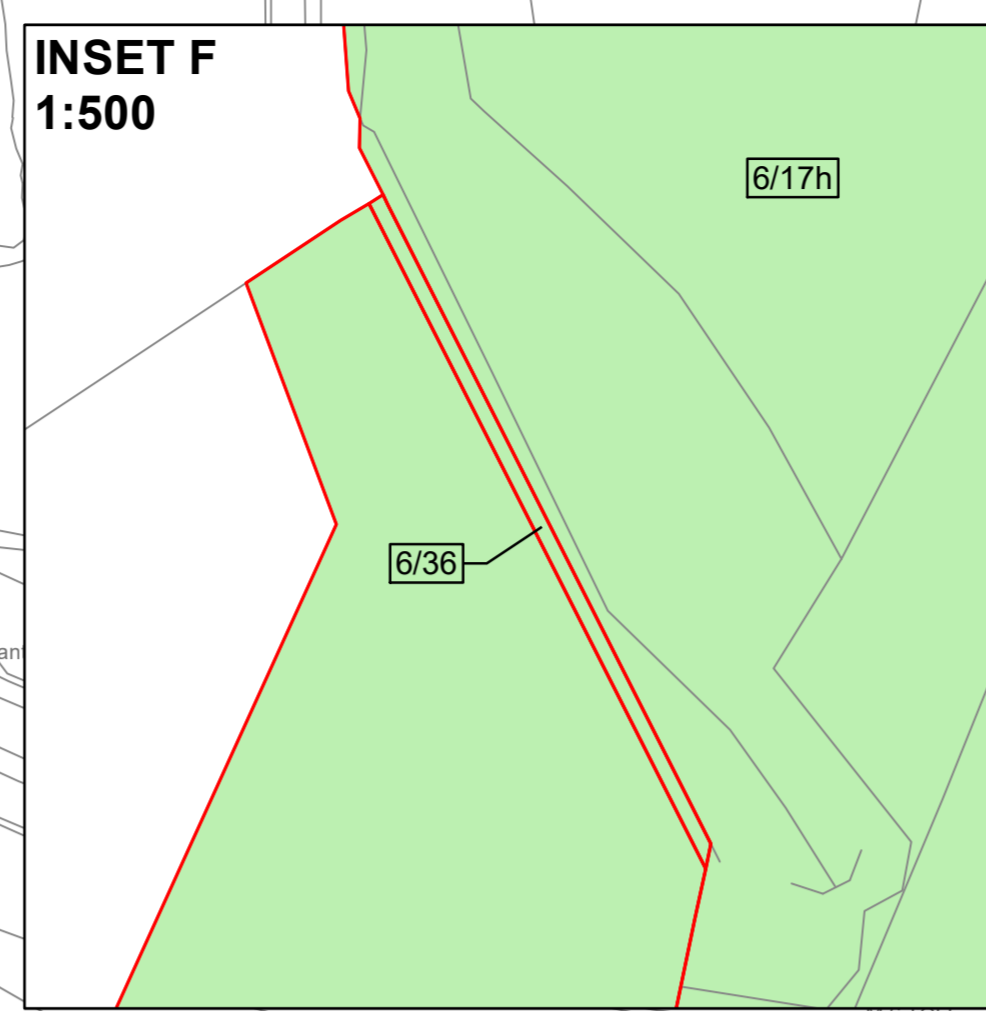
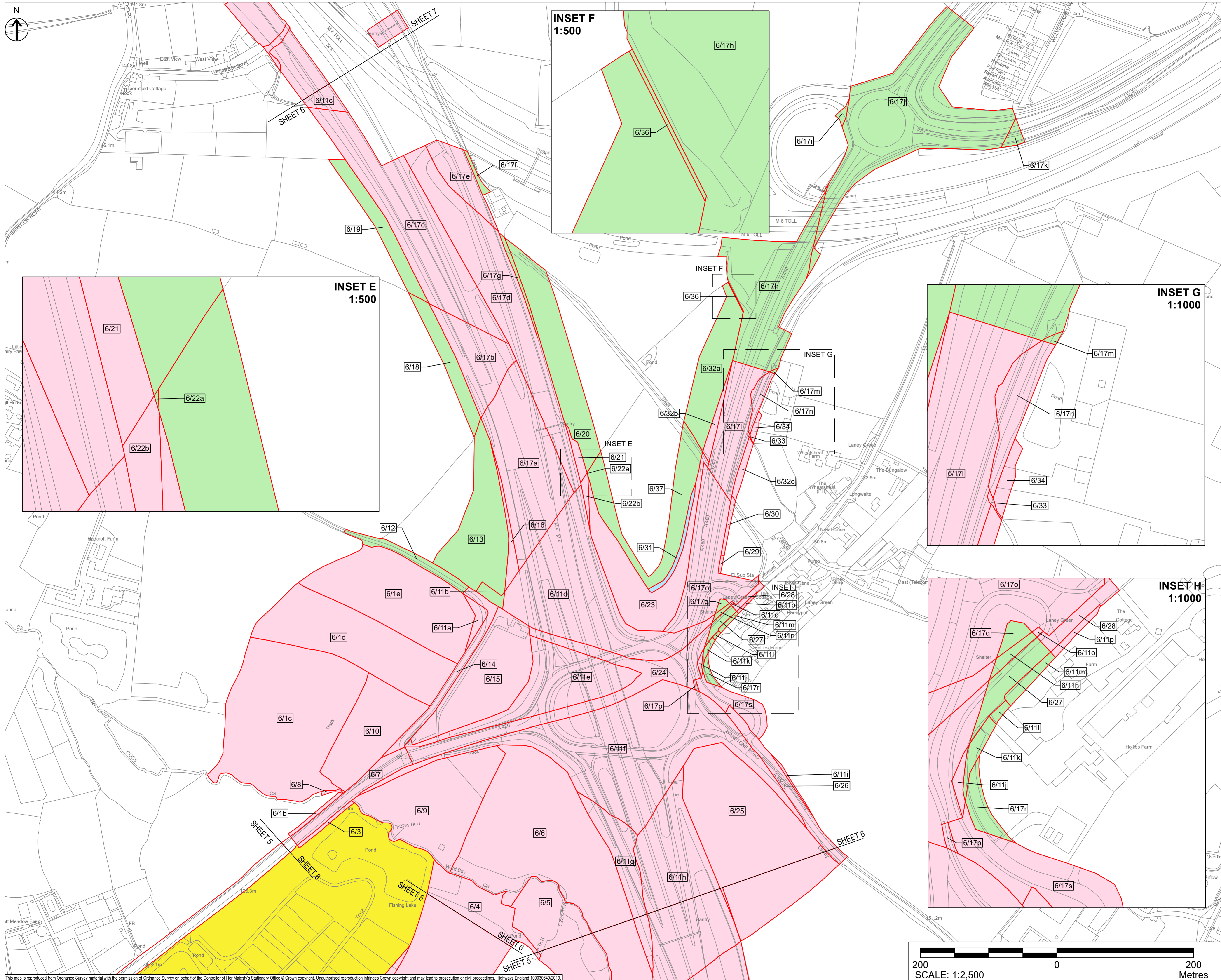
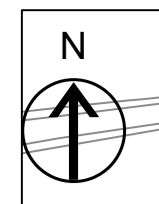

- NOTES**
1. ALL DIMENSIONS IN METRES UNLESS STATED OTHERWISE.
 2. DO NOT SCALE FROM THIS DRAWING. USE ONLY PRINTED DIMENSIONS.
 3. ALL EASEMENTS, SERVITUDES AND PRIVATE RIGHTS ARE PROPOSED TO BE EXTINGUISHED ON LAND THAT IS TO BE ACQUIRED UNLESS STATED OTHERWISE IN THE BOOK OF REFERENCE.
 4. THIS DRAWING IS TO BE READ IN CONJUNCTION WITH ALL OTHER PLANS AND DOCUMENTATION, IN PARTICULAR THE WORK PLANS AND THE BOOK OF REFERENCE.
- KEY**
- LIMITS OF LAND TO BE ACQUIRED OR USED PERMANENTLY OR TEMPORARILY (THE ORDER LIMITS)
 - [23] PLOT REFERENCE NUMBER (REFER TO BOOK OF REFERENCE FOR FURTHER INFORMATION)
 - LAND NOT INCLUDED WITHIN THE ORDER LIMITS
 - LAND TO BE ACQUIRED PERMANENTLY
 - LAND TO BE USED TEMPORARILY
 - LAND TO BE USED TEMPORARILY AND RIGHTS TO BE ACQUIRED PERMANENTLY
 - NO POWERS SOUGHT IN DCO

Issue	LD	SM	Date	Ref
First Issue	LD	SM	21/10/19	P01
Update following client review	LD	SM	05/11/19	P02
Minor amendments to drawing frame	LD	SM	22/11/19	P03
Pre DCO Submission Amendments	LD	SM	16/12/19	P04
Plot amendments following client review	CH	SM	16/01/20	P05
Updates to plot numbers and minor drawing frame amendments	CH	SM	24/01/20	P06
Revision Details	By	Check	Date	Suffix

DCO APPLICATION

Client:
Highways England
2 Colmore Square
38 Colmore Circus
Birmingham
B4 6BN



Development Consent Order Number
TR010054

Project Title
M54 to M6 Link Road

Development Consent Order Drawing Number
TR010054/APP/2.2

Drawing Title
**LAND PLANS
REGULATION 5(2)(i)
SHEET 6 OF 10**

Designed	Drawn	Checked	Approved	Date
SM	CH	JB	SM	24/01/20

Internal Project No. 60536736
Scale @ A1 1:2500
Zone Development Consent Order

THIS DOCUMENT HAS BEEN PREPARED PURSUANT TO AND SUBJECT TO THE TERMS OF AECOM'S APPOINTMENT BY ITS CLIENT. AECOM ACCEPTS NO LIABILITY FOR ANY USE OF THIS DOCUMENT OTHER THAN BY ITS ORIGINAL CLIENT OR FOLLOWING AECOM'S EXPRESS AGREEMENT TO SUCH USE, AND ONLY FOR THE PURPOSES FOR WHICH IT WAS PREPARED AND PROVIDED.

Drawing Number	Originator	Volume	Rev
HE514465	-GHX	-LLO	P06
Location	Type	Role	Number
Z2_SW_PR_Z	-DR-LR-1006		



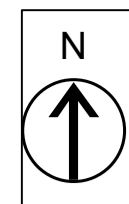

- NOTES**
1. ALL DIMENSIONS IN METRES UNLESS STATED OTHERWISE.
 2. DO NOT SCALE FROM THIS DRAWING. USE ONLY PRINTED DIMENSIONS.
 3. ALL EASEMENTS, SERVITUDES AND PRIVATE RIGHTS ARE PROPOSED TO BE EXTINGUISHED ON LAND THAT IS TO BE ACQUIRED UNLESS STATED OTHERWISE IN THE BOOK OF REFERENCE.
 4. THIS DRAWING IS TO BE READ IN CONJUNCTION WITH ALL OTHER PLANS AND DOCUMENTATION. IN PARTICULAR THE WORK PLANS AND THE BOOK OF REFERENCE.

- KEY**
- LIMITS OF LAND TO BE ACQUIRED OR USED PERMANENTLY OR TEMPORARILY (THE ORDER LIMITS)
 - 7/1d PLOT REFERENCE NUMBER (REFER TO BOOK OF REFERENCE FOR FURTHER INFORMATION)
 - LAND NOT INCLUDED WITHIN THE ORDER LIMITS
 - LAND TO BE ACQUIRED PERMANENTLY
 - LAND TO BE USED TEMPORARILY
 - LAND TO BE USED TEMPORARILY AND RIGHTS TO BE ACQUIRED PERMANENTLY
 - NO POWERS SOUGHT IN DCO

First Issue	LD	SM	21/10/19	P01
Update following client review	LD	SM	05/11/19	P02
Minor amendments to drawing frame	LD	SM	22/11/19	P03
Pre DCO Submission Amendments	LD	SM	16/12/19	P04
Plot amendments following client review	CH	SM	16/01/20	P05
Updates to plot numbers and minor drawing frame amendments	CH	SM	24/01/20	P06
Revision Details	By	Check	Date	Suffix

DCO APPLICATION

Client:
Highways England
2 Colmore Square
38 Colmore Circus
Birmingham
B4 6BN



Development Consent Order Number
TR010054

Project Title
M54 to M6 Link Road

Development Consent Order Drawing Number
TR010054/APP/2.2

**LAND PLANS
REGULATION 5(2)(i)
SHEET 7 OF 10**

Designed SM	Drawn CH	Checked JB	Approved SM	Date 24/01/20
Internal Project No. 60536736	Suitability S8			
Scale @ A1 1:2500	Zone Development Consent Order			

THIS DOCUMENT HAS BEEN PREPARED PURSUANT TO AND SUBJECT TO THE TERMS OF AECOM'S APPOINTMENT BY ITS CLIENT. AECOM ACCEPTS NO LIABILITY FOR ANY USE OF THIS DOCUMENT OTHER THAN BY ITS ORIGINAL CLIENT OR FOLLOWING AECOM'S EXPRESS AGREEMENT TO SUCH USE, AND ONLY FOR THE PURPOSES FOR WHICH IT WAS PREPARED AND PROVIDED.

Drawing Number HE514465	Originator -GHC	Volume -LLO	Rev P06
Location Z3_SW_PR_Z	Type -DR-LR-1007	Role -DR-LR-1007	Number



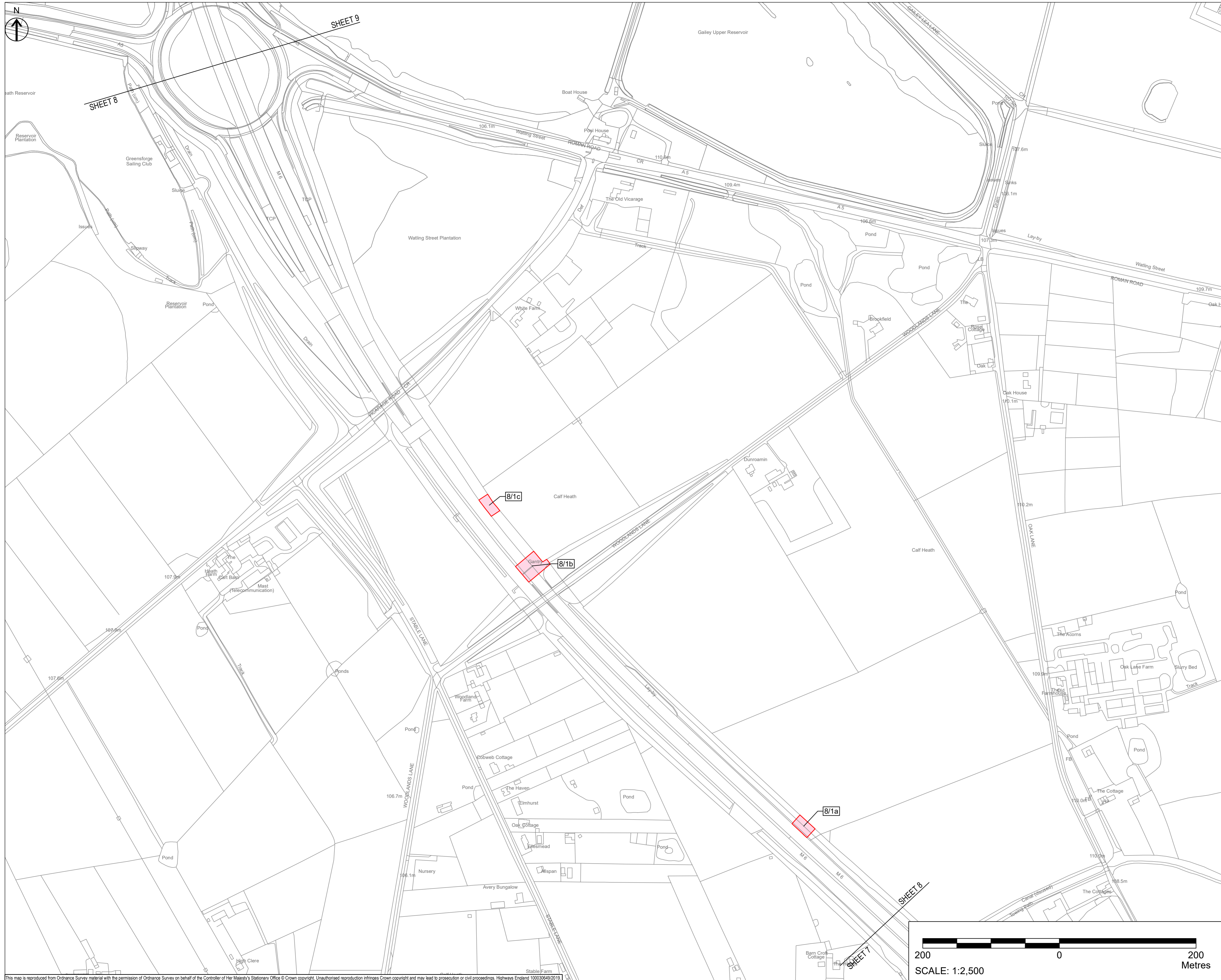

- NOTES
1. ALL DIMENSIONS IN METRES UNLESS STATED OTHERWISE.
 2. DO NOT SCALE FROM THIS DRAWING. USE ONLY PRINTED DIMENSIONS.
 3. ALL EASEMENTS, SERVITUDES AND PRIVATE RIGHTS ARE PROPOSED TO BE EXTINGUISHED ON LAND THAT IS TO BE ACQUIRED UNLESS STATED OTHERWISE IN THE BOOK OF REFERENCE.
 4. THIS DRAWING IS TO BE READ IN CONJUNCTION WITH ALL OTHER PLANS AND DOCUMENTATION, IN PARTICULAR THE WORK PLANS AND THE BOOK OF REFERENCE.

- KEY
- LIMITS OF LAND TO BE ACQUIRED OR USED PERMANENTLY OR TEMPORARILY (THE ORDER LIMITS)
 - PLOT REFERENCE NUMBER (REFER TO BOOK OF REFERENCE FOR FURTHER INFORMATION)
 - LAND NOT INCLUDED WITHIN THE ORDER LIMITS
 - LAND TO BE ACQUIRED PERMANENTLY
 - LAND TO BE USED TEMPORARILY
 - LAND TO BE USED TEMPORARILY AND RIGHTS TO BE ACQUIRED PERMANENTLY
 - NO POWERS SOUGHT IN DCO

First Issue	LD	SM	21/10/19	P01
Update following client review	LD	SM	05/11/19	P02
Minor amendments to drawing frame	LD	SM	22/11/19	P03
Pre DCO Submission Amendments	LD	SM	16/12/19	P04
Plot amendments following client review	CH	SM	16/01/20	P05
Updates to plot numbers and minor drawing frame amendments	CH	SM	24/01/20	P06
Revision Details	By	Check	Date	Suffix

DCO APPLICATION

Client:
Highways England
2 Colmore Square
38 Colmore Circus
Birmingham
B4 6BN



Development Consent Order Number
TR010054

Project Title
M54 to M6 Link Road

Development Consent Order Drawing Number
TR010054/APP/2.2

**LAND PLANS
REGULATION 5(2)(i)
SHEET 8 OF 10**

Designed SM	Drawn CH	Checked JB	Approved SM	Date 24/01/20
Internal Project No. 60536736		Suitability S8		
Scale @ A1 1:2500		Zone Development Consent Order		

THIS DOCUMENT HAS BEEN PREPARED PURSUANT TO AND SUBJECT TO THE TERMS OF AECOM'S APPOINTMENT BY ITS CLIENT. AECOM ACCEPTS NO LIABILITY FOR ANY USE OF THIS DOCUMENT OTHER THAN BY ITS ORIGINAL CLIENT OR FOLLOWING AECOM'S EXPRESS AGREEMENT TO SUCH USE, AND ONLY FOR THE PURPOSES FOR WHICH IT WAS PREPARED AND PROVIDED.

Drawing Number HE514465	Originator -GHX	Volume -LLO	Rev P06
Location Z3_SW_PR_Z	Type -DR-LR-1008	Role -DR-LR-1008	Number



This map is reproduced from Ordnance Survey material with the permission of Ordnance Survey on behalf of the Controller of Her Majesty's Stationery Office © Crown copyright. Unauthorised reproduction infringes Crown copyright and may lead to prosecution or civil proceedings. Highways England 10003649/2019

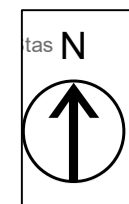
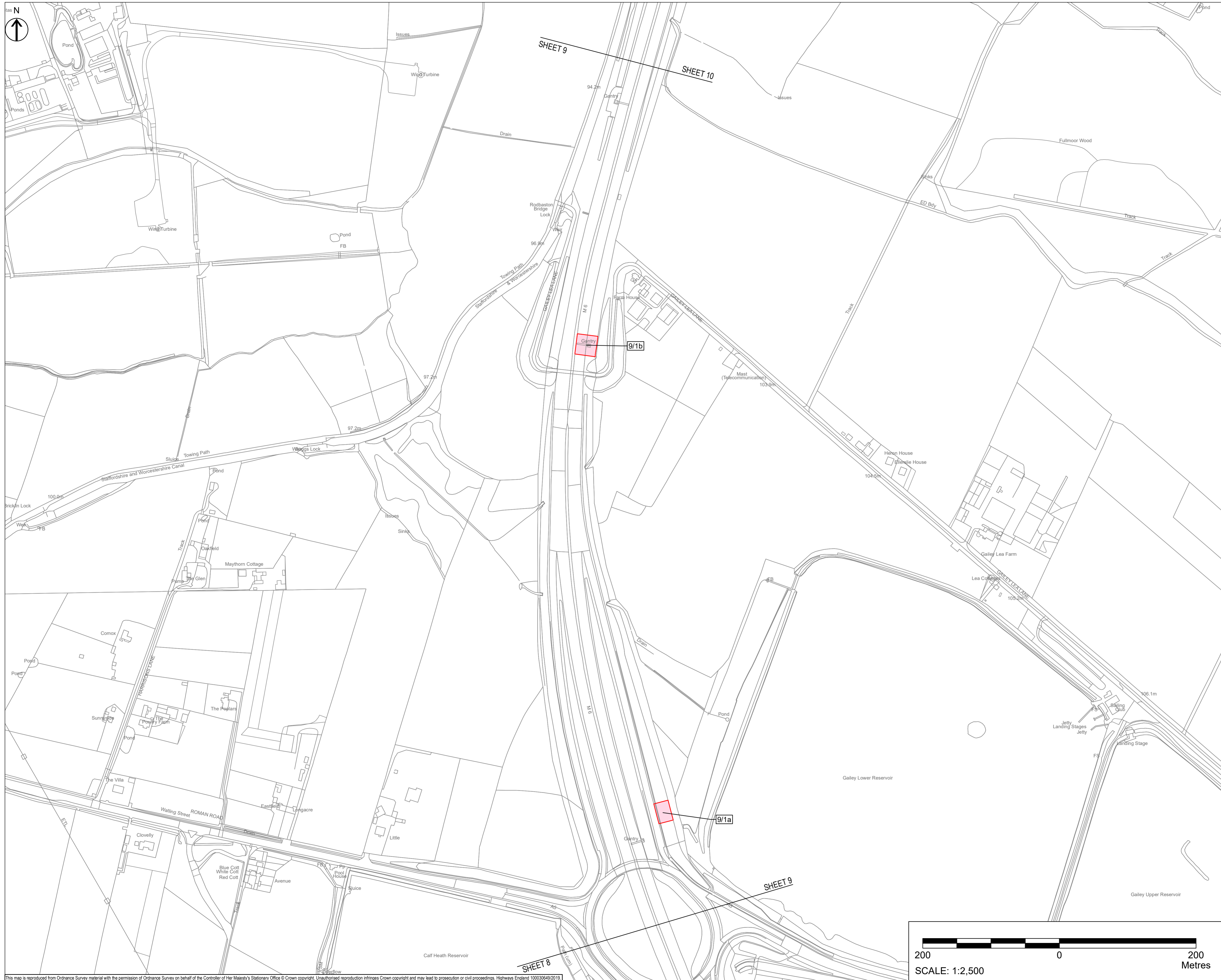

- NOTES**
1. ALL DIMENSIONS IN METRES UNLESS STATED OTHERWISE.
 2. DO NOT SCALE FROM THIS DRAWING. USE ONLY PRINTED DIMENSIONS.
 3. ALL EASEMENTS, SERVITUDES AND PRIVATE RIGHTS ARE PROPOSED TO BE EXTINGUISHED ON LAND THAT IS TO BE ACQUIRED UNLESS STATED OTHERWISE IN THE BOOK OF REFERENCE.
 4. THIS DRAWING IS TO BE READ IN CONJUNCTION WITH ALL OTHER PLANS AND DOCUMENTATION, IN PARTICULAR THE WORK PLANS AND THE BOOK OF REFERENCE.

- KEY**
- LIMITS OF LAND TO BE ACQUIRED OR USED PERMANENTLY OR TEMPORARILY (THE ORDER LIMITS)
 - PLOT REFERENCE NUMBER (REFER TO BOOK OF REFERENCE FOR FURTHER INFORMATION)
 - LAND NOT INCLUDED WITHIN THE ORDER LIMITS
 - LAND TO BE ACQUIRED PERMANENTLY
 - LAND TO BE USED TEMPORARILY
 - LAND TO BE USED TEMPORARILY AND RIGHTS TO BE ACQUIRED PERMANENTLY
 - NO POWERS SOUGHT IN DCO

Revision	By	Check	Date	Suffix
First Issue	LD	SM	21/10/19	P01
Update following client review	LD	SM	05/11/19	P02
Minor amendments to drawing frame	LD	SM	22/11/19	P03
Pre DCO Submission Amendments	LD	SM	16/12/19	P04
Plot amendments following client review	CH	SM	16/01/20	P05
Updates to plot numbers and minor drawing frame amendments	CH	SM	24/01/20	P06

DCO APPLICATION

Client:
Highways England
2 Colmore Square
38 Colmore Circus
Birmingham
B4 6BN



Development Consent Order Number:
TR010054

Project Title:
M54 to M6 Link Road

Development Consent Order Drawing Number:
TR010054/APP/2.2

**LAND PLANS
REGULATION 5(2)(i)
SHEET 9 OF 10**

Designed	Drawn	Checked	Approved	Date
SM	CH	JB	SM	24/01/20

Internal Project No. 60536736
Scale @ A1 1:2500
Sustainability S8
Zone Development Consent Order

THIS DOCUMENT HAS BEEN PREPARED PURSUANT TO AND SUBJECT TO THE TERMS OF AECOM'S APPOINTMENT BY ITS CLIENT. AECOM ACCEPTS NO LIABILITY FOR ANY USE OF THIS DOCUMENT OTHER THAN BY ITS ORIGINAL CLIENT OR FOLLOWING AECOM'S EXPRESS AGREEMENT TO SUCH USE, AND ONLY FOR THE PURPOSES FOR WHICH IT WAS PREPARED AND PROVIDED.

Drawing Number	Highways England PIN	Originator	Volume	Rev
HE514465	-GHX	-LLO		P06
Z3_SW_PR_Z		-DR-LR-1009		

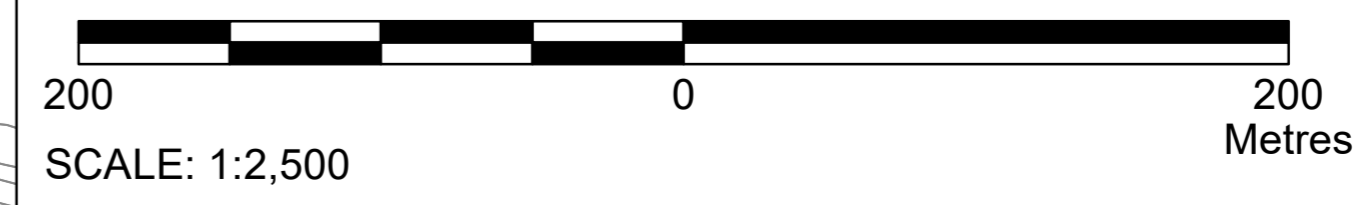

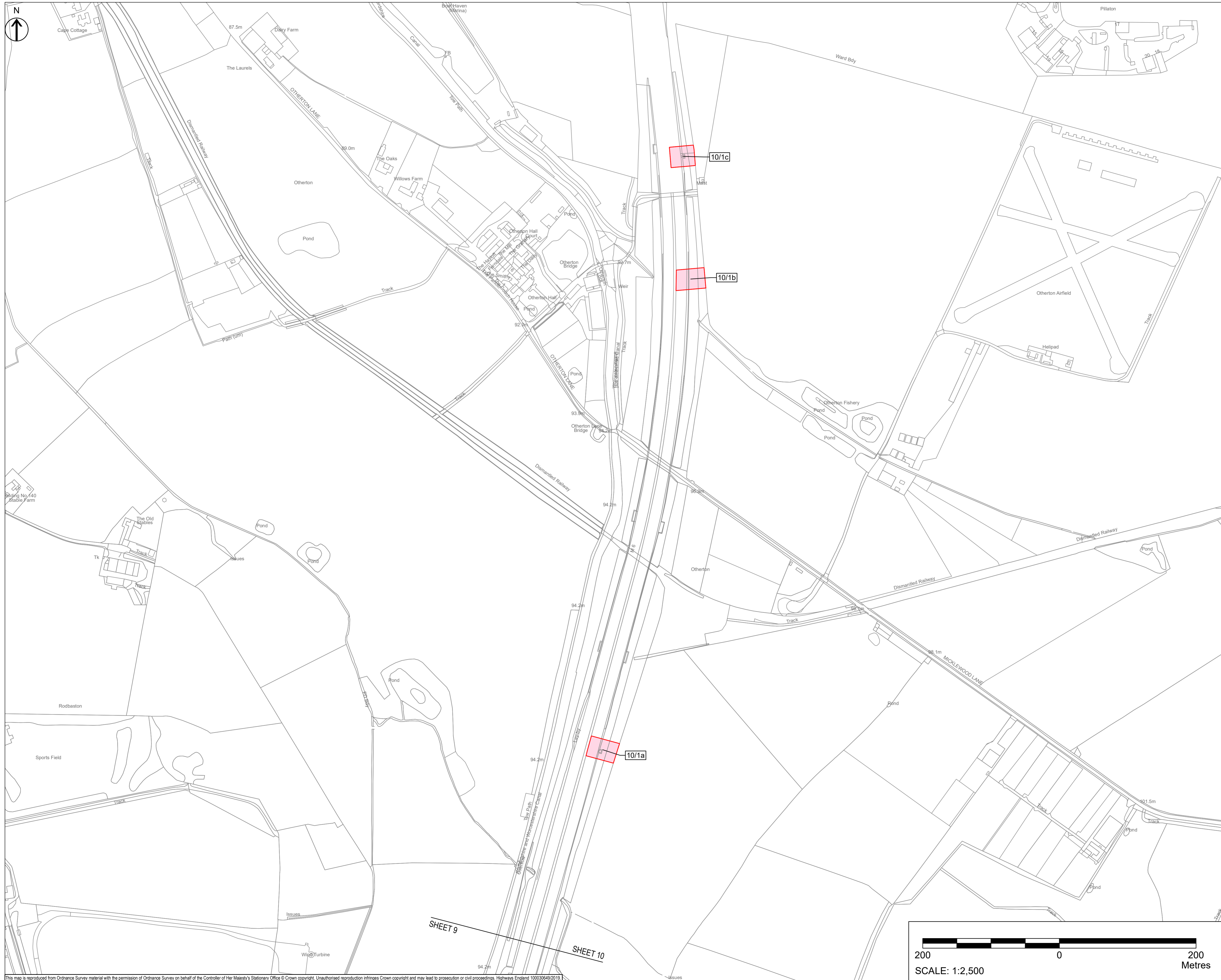

- NOTES**
1. ALL DIMENSIONS IN METRES UNLESS STATED OTHERWISE.
 2. DO NOT SCALE FROM THIS DRAWING. USE ONLY PRINTED DIMENSIONS.
 3. ALL EASEMENTS, SERVITUDES AND PRIVATE RIGHTS ARE PROPOSED TO BE EXTINGUISHED ON LAND THAT IS TO BE ACQUIRED UNLESS STATED OTHERWISE IN THE BOOK OF REFERENCE.
 4. THIS DRAWING IS TO BE READ IN CONJUNCTION WITH ALL OTHER PLANS AND DOCUMENTATION, IN PARTICULAR THE WORK PLANS AND THE BOOK OF REFERENCE.

- KEY**
- LIMITS OF LAND TO BE ACQUIRED OR USED PERMANENTLY OR TEMPORARILY (THE ORDER LIMITS)
 - 123 PLOT REFERENCE NUMBER (REFER TO BOOK OF REFERENCE FOR FURTHER INFORMATION)
 - LAND NOT INCLUDED WITHIN THE ORDER LIMITS
 - LAND TO BE ACQUIRED PERMANENTLY
 - LAND TO BE USED TEMPORARILY
 - LAND TO BE USED TEMPORARILY AND RIGHTS TO BE ACQUIRED PERMANENTLY
 - NO POWERS SOUGHT IN DCO

Issue	LD	SM	Date	Suffix
First Issue	LD	SM	21/10/19	P01
Update following client review	LD	SM	05/11/19	P02
Minor amendments to drawing frame	LD	SM	22/11/19	P03
Pre DCO Submission Amendments	LD	SM	16/12/19	P04
Plot amendments following client review	CH	SM	16/01/20	P05
Updates to plot numbers and minor drawing frame amendments	CH	SM	24/01/20	P06
Revision Details	By	Check	Date	Suffix

DCO APPLICATION

Client:
Highways England
2 Colmore Square
38 Colmore Circus
Birmingham
B4 6BN



Development Consent Order Number
TR010054

Project Title
M54 to M6 Link Road

Development Consent Order Drawing Number
TR010054/APP/2.2

**LAND PLANS
REGULATION 5(2)(i)
SHEET 10 OF 10**

Designed SM	Drawn CH	Checked JB	Approved SM	Date 24/01/20
Internal Project No. 60536736		Suitability S8		
Scale @ A1 1:2500		Zone Development Consent Order		

THIS DOCUMENT HAS BEEN PREPARED PURSUANT TO AND SUBJECT TO THE TERMS OF AECOM'S APPOINTMENT BY ITS CLIENT. AECOM ACCEPTS NO LIABILITY FOR ANY USE OF THIS DOCUMENT OTHER THAN BY ITS ORIGINAL CLIENT OR FOLLOWING AECOM'S EXPRESS AGREEMENT TO SUCH USE, AND ONLY FOR THE PURPOSES FOR WHICH IT WAS PREPARED AND PROVIDED.

Drawing Number HE514465	Originator -GHX	Volume -LLO	Rev P06
Location Z3_SW_PR_Z	Type -DR-LR-1010	Role -DR-LR-1010	Number

